

ADDENDUM NO. 2 - TO  
 SPECIFICATIONS AND CONTRACT DOCUMENTS  
 POWELL MIDDLE SCHOOL HVAC AND ELECTRICAL IMPROVEMENTS  
 3655 LIVINGSTON ROAD  
 JACKSON, MISSISSIPPI

Nov 1 " # \$\$, 2%2&

This addendum forms a part of the Contract Documents and modifies the original specifications and drawings in # dated 10-15-24 as noted below. The contractor shall acknowledge receipt of this Addendum in the space provided on the attached form. Failure to do so may constitute a breach of the contract.

This Addendum consists of 1 page and 3 attachments.

Item No. 10 12E3T/4N5AN36E70 See attached 1 question. Answers consist of 1 page.

Item No. 20 D7A6/N83#39EET A1&0 : 3/TE ;<AN0 Remove and destroy this sheet and insert the attached revised sheet A1&0 : 3/TE ;<AN dated 11-11-24.

Item No. 30 D7A6/N83#39EET A1&2 : \*/73T \*<447 ;<AN A7EAC0 Remove and destroy this sheet and insert the attached revised sheet A1&2 : \*/73T \*<447 ;<AN A7EAC dated 11-11-24.

Item No. 40 D7A6/N83#39EET A1&3 : \*/N/39 3C9ED2<E



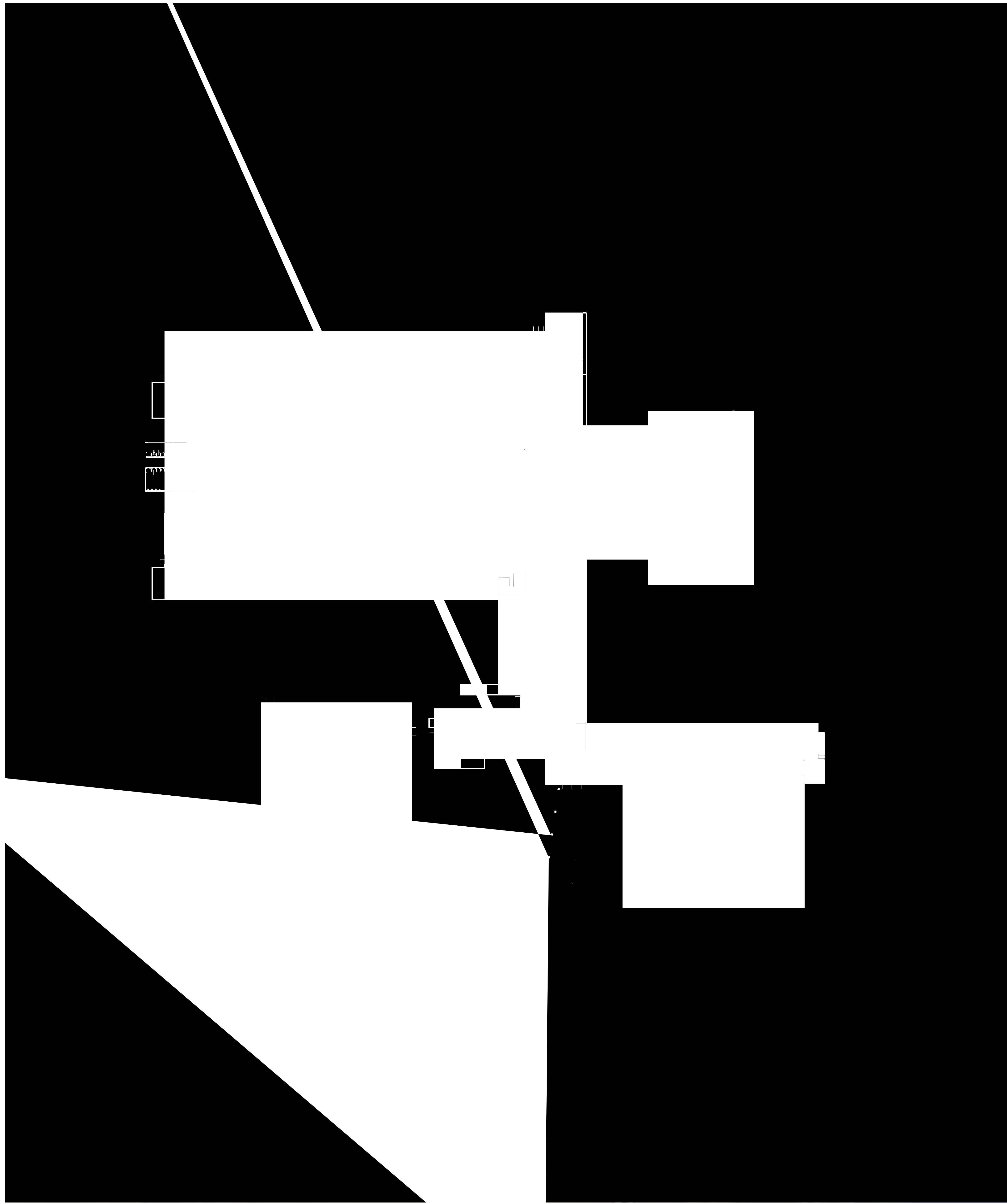









=====

